

## **Delegated Decision**

**6 February 2024**

**Temporary Traffic Regulation Order**

**Ordinary Decision/Key Decision No.**



---

## **Report of NEIGHBOURHOODS & CLIMATE CHANGE**

**Paul Anderson – Strategic Highways Manager, Technical Services**

### **Electoral division(s) affected:**

Esh & Witton Gilbert Ward: Cllr A Simpson, Cllr B Coult

### **Purpose of the Report**

To consider a request for temporary traffic regulation by Order from 25 March 2024 for the purpose of new Virgin Media infrastructure installation works on Garden Avenue and The Crescent, Langley Park.

### **Recommendation**

It is recommended that the Council exercises its powers under the Road Traffic Regulation Act 1984 to effect a Temporary Traffic Regulation Order to facilitate the proposed works

### **Background**

Works are proposed by Avonline on behalf of Virgin Media to undertake new telecom supply works within the confines of the highway.

### **Options**

Other traffic management arrangements have been considered and the most appropriate method is for temporary road closure for approx. 3-4 weeks.

### **Recommendation**

The recommendation is approved and that following, consultations with the Chief of Police, arrangements be made to progress the advertising of Public Notices and sealing of an Order.

---

**Contact:** Steven Galloway

Tel: 03000 267095

---

---

## **Appendix 1: Implications**

---

### **Legal Implications**

TTRO checked, prepared and advertised via Legal Services

### **Finance**

Costs to be charged to the scheme/applicant.

### **Consultation**

Chief of Police, Local Members, Public Transport Providers (via the Public Transport Team)

### **Equality and Diversity / Public Sector Equality Duty**

N/A

### **Human Rights**

No impact

### **Crime and Disorder**

N/A

### **Climate Change**

N/A

### **Staffing**

Network Management Team

### **Accommodation**

N/A

### **Risk**

N/A

### **Procurement**

Advertising in a public newspaper with costs recharged to the scheme/applicant

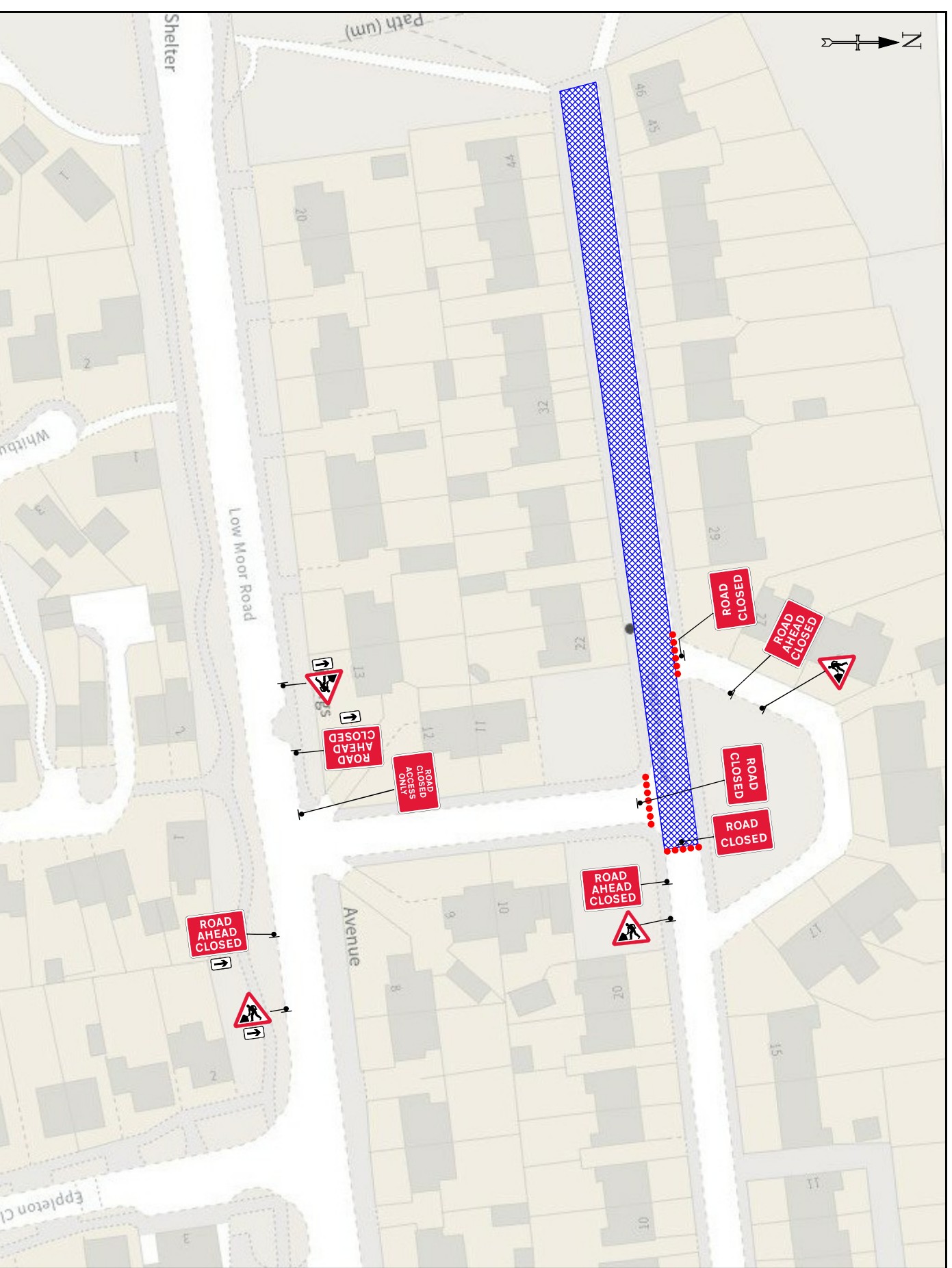

TEMPORARY  
TRAFFIC MANAGEMENT  
30 MPH

Issue	Date
1	23/01/24
Drawn By	JC

ROAD CLOSURE  
GARDEN AVENUE, LANGLEY PARK, DURHAM  
DH7 9UJ

Original drawing size A3 - NTS  
Drawing Ref: AVONLINE

**KEY**

- Traffic sign
- Traffic cone
- Traffic signals to Diagram 3000.1
- Working Space
- Pedestrian Barrier

**Notes -**  
RESIDENTS TO BE PRE WARNED ABOUT RESTRICTED ACCESS / EGRESS WHILE JOB IS IN SITU

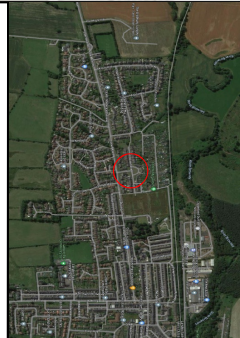

**Specials -**

Maximum width	Standard barrier traffic including bases and signs	Restricted clear and light vehicles only
1.20 m maximum	1.50 m maximum	1.50 m maximum
1.50 m maximum	1.50 m maximum	2.20 m maximum
3.00 m maximum	3.00 m maximum	3.00 m maximum

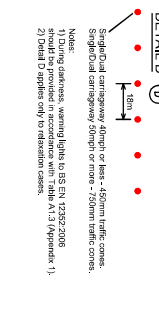

**DETAIL B**

- Single dual carriageway, single or two-lane - 400mm traffic cones, spacing 1.5m.
- Single dual carriageway, dual speed limit - 750mm traffic cones, spacing 1.5m, roadward side.
- Single dual carriageway, national speed limit - 750mm traffic cones, spacing 1.5m, roadward side.

**Notes:**

- 1) During darkness, warning lights to BS EN 12353:2006 should be provided in accordance with Table A.1.3 (Appendix 1).
- 2) 400mm traffic cones, 1.5m spacing, no additional cones.
- 3) 750mm traffic cones, 1.5m spacing, no additional cones.
- 4) 750mm traffic cones, 1.5m spacing, no additional cones.
- 5) 750mm traffic cones, 1.5m spacing, no additional cones.
- 6) 750mm traffic cones, 1.5m spacing, no additional cones.
- 7) 750mm traffic cones, 1.5m spacing, no additional cones.
- 8) 750mm traffic cones, 1.5m spacing, no additional cones.
- 9) 750mm traffic cones, 1.5m spacing, no additional cones.
- 10) 750mm traffic cones, 1.5m spacing, no additional cones.
- 11) 750mm traffic cones, 1.5m spacing, no additional cones.
- 12) 750mm traffic cones, 1.5m spacing, no additional cones.
- 13) 750mm traffic cones, 1.5m spacing, no additional cones.
- 14) 750mm traffic cones, 1.5m spacing, no additional cones.
- 15) 750mm traffic cones, 1.5m spacing, no additional cones.
- 16) 750mm traffic cones, 1.5m spacing, no additional cones.
- 17) 750mm traffic cones, 1.5m spacing, no additional cones.
- 18) 750mm traffic cones, 1.5m spacing, no additional cones.
- 19) 750mm traffic cones, 1.5m spacing, no additional cones.
- 20) 750mm traffic cones, 1.5m spacing, no additional cones.
- 21) 750mm traffic cones, 1.5m spacing, no additional cones.
- 22) 750mm traffic cones, 1.5m spacing, no additional cones.
- 23) 750mm traffic cones, 1.5m spacing, no additional cones.
- 24) 750mm traffic cones, 1.5m spacing, no additional cones.
- 25) 750mm traffic cones, 1.5m spacing, no additional cones.
- 26) 750mm traffic cones, 1.5m spacing, no additional cones.
- 27) 750mm traffic cones, 1.5m spacing, no additional cones.
- 28) 750mm traffic cones, 1.5m spacing, no additional cones.
- 29) 750mm traffic cones, 1.5m spacing, no additional cones.
- 30) 750mm traffic cones, 1.5m spacing, no additional cones.
- 31) 750mm traffic cones, 1.5m spacing, no additional cones.
- 32) 750mm traffic cones, 1.5m spacing, no additional cones.
- 33) 750mm traffic cones, 1.5m spacing, no additional cones.
- 34) 750mm traffic cones, 1.5m spacing, no additional cones.
- 35) 750mm traffic cones, 1.5m spacing, no additional cones.
- 36) 750mm traffic cones, 1.5m spacing, no additional cones.
- 37) 750mm traffic cones, 1.5m spacing, no additional cones.
- 38) 750mm traffic cones, 1.5m spacing, no additional cones.
- 39) 750mm traffic cones, 1.5m spacing, no additional cones.
- 40) 750mm traffic cones, 1.5m spacing, no additional cones.
- 41) 750mm traffic cones, 1.5m spacing, no additional cones.
- 42) 750mm traffic cones, 1.5m spacing, no additional cones.
- 43) 750mm traffic cones, 1.5m spacing, no additional cones.
- 44) 750mm traffic cones, 1.5m spacing, no additional cones.
- 45) 750mm traffic cones, 1.5m spacing, no additional cones.
- 46) 750mm traffic cones, 1.5m spacing, no additional cones.
- 47) 750mm traffic cones, 1.5m spacing, no additional cones.
- 48) 750mm traffic cones, 1.5m spacing, no additional cones.
- 49) 750mm traffic cones, 1.5m spacing, no additional cones.
- 50) 750mm traffic cones, 1.5m spacing, no additional cones.
- 51) 750mm traffic cones, 1.5m spacing, no additional cones.
- 52) 750mm traffic cones, 1.5m spacing, no additional cones.
- 53) 750mm traffic cones, 1.5m spacing, no additional cones.
- 54) 750mm traffic cones, 1.5m spacing, no additional cones.
- 55) 750mm traffic cones, 1.5m spacing, no additional cones.
- 56) 750mm traffic cones, 1.5m spacing, no additional cones.
- 57) 750mm traffic cones, 1.5m spacing, no additional cones.
- 58) 750mm traffic cones, 1.5m spacing, no additional cones.
- 59) 750mm traffic cones, 1.5m spacing, no additional cones.
- 60) 750mm traffic cones, 1.5m spacing, no additional cones.
- 61) 750mm traffic cones, 1.5m spacing, no additional cones.
- 62) 750mm traffic cones, 1.5m spacing, no additional cones.
- 63) 750mm traffic cones, 1.5m spacing, no additional cones.
- 64) 750mm traffic cones, 1.5m spacing, no additional cones.
- 65) 750mm traffic cones, 1.5m spacing, no additional cones.
- 66) 750mm traffic cones, 1.5m spacing, no additional cones.
- 67) 750mm traffic cones, 1.5m spacing, no additional cones.
- 68) 750mm traffic cones, 1.5m spacing, no additional cones.
- 69) 750mm traffic cones, 1.5m spacing, no additional cones.
- 70) 750mm traffic cones, 1.5m spacing, no additional cones.
- 71) 750mm traffic cones, 1.5m spacing, no additional cones.
- 72) 750mm traffic cones, 1.5m spacing, no additional cones.
- 73) 750mm traffic cones, 1.5m spacing, no additional cones.
- 74) 750mm traffic cones, 1.5m spacing, no additional cones.
- 75) 750mm traffic cones, 1.5m spacing, no additional cones.
- 76) 750mm traffic cones, 1.5m spacing, no additional cones.
- 77) 750mm traffic cones, 1.5m spacing, no additional cones.
- 78) 750mm traffic cones, 1.5m spacing, no additional cones.
- 79) 750mm traffic cones, 1.5m spacing, no additional cones.
- 80) 750mm traffic cones, 1.5m spacing, no additional cones.
- 81) 750mm traffic cones, 1.5m spacing, no additional cones.
- 82) 750mm traffic cones, 1.5m spacing, no additional cones.
- 83) 750mm traffic cones, 1.5m spacing, no additional cones.
- 84) 750mm traffic cones, 1.5m spacing, no additional cones.
- 85) 750mm traffic cones, 1.5m spacing, no additional cones.
- 86) 750mm traffic cones, 1.5m spacing, no additional cones.
- 87) 750mm traffic cones, 1.5m spacing, no additional cones.
- 88) 750mm traffic cones, 1.5m spacing, no additional cones.
- 89) 750mm traffic cones, 1.5m spacing, no additional cones.
- 90) 750mm traffic cones, 1.5m spacing, no additional cones.
- 91) 750mm traffic cones, 1.5m spacing, no additional cones.
- 92) 750mm traffic cones, 1.5m spacing, no additional cones.
- 93) 750mm traffic cones, 1.5m spacing, no additional cones.
- 94) 750mm traffic cones, 1.5m spacing, no additional cones.
- 95) 750mm traffic cones, 1.5m spacing, no additional cones.
- 96) 750mm traffic cones, 1.5m spacing, no additional cones.
- 97) 750mm traffic cones, 1.5m spacing, no additional cones.
- 98) 750mm traffic cones, 1.5m spacing, no additional cones.
- 99) 750mm traffic cones, 1.5m spacing, no additional cones.
- 100) 750mm traffic cones, 1.5m spacing, no additional cones.